

技术参数

声光介质	Crystalline Quartz
声速	5.74 mm/μs
透光孔径*	0.2 mm 'L' X 0.25 mm 'H'
中心频率	250 MHz
射频带宽	80 MHz @ -10 dB Return Loss
输入阻抗	50 Ohms Nominal
驻波比	1.4 :1 Max
波长	532 nm
插入损耗	2 % Max
单面反射率	.5 % Max
增透膜标准	MIL-C-48497
光功率密度	N/A W/mm ²
消光比	1000 :1 Min
偏振	90 ° To Mounting Plane

波长性能参数

波长(nm)	532
饱和射频功率 (W)	6.6
布拉格角 (mr)	11.6
光束分离角 (mr)	23.2

光束直径性能参数

光束直径(μm)	150
波长(nm)	532
衍射效率(%)	90
上升时间(ns)	21
调制带宽	

*透光孔径：性能指标适用的光学孔径范围

外形尺寸图:

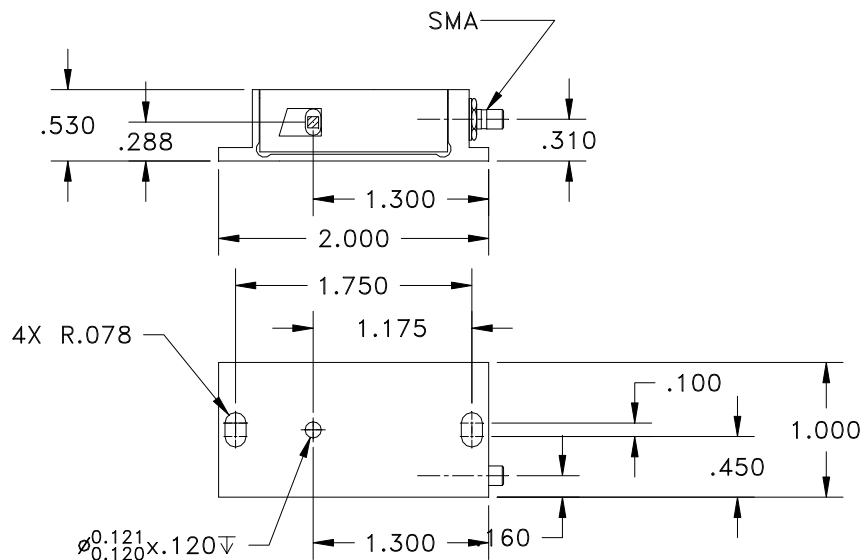

Document

10/31/13

Control

Notes:



THIS DOCUMENT IS THE PROPERTY OF GOOCH AND HOUSEGO. IT IS NOT TO BE REPRODUCED OR DISCLOSED IN WHOLE OR IN PART OTHER THAN BY EMPLOYEES OF GOOCH AND HOUSEGO AND ITS CONTRACTED REPRESENTATIVES AND DISTRIBUTORS. ANY EXCEPTION REQUIRES THE WRITTEN CONSENT OF AN AUTHORIZED REPRESENTATIVE OF GOOCH AND HOUSEGO.

TOLERANCES: .XX ± .01 .XXX ± .005	DR	A. Campi 10/7/2013	Gooch & Housego	
MATERIAL:	CHK		DESCRIPTION: AOMO 3250-220 532 nm	
FINISH:	APP		PART NUMBER: 97-02965-01	REV: B
	APP			SHEET 1 OF 1