

技术参数

声光介质			TeO ₂
声速			4.2 mm/μs
通光孔径*	2.5 mm 'L' X	1.5 mm 'H'	
中心频率			200 MHz
射频带宽	50 MHz @	-10 dB Return Loss	
输入阻抗			50 Ohms Nominal
驻波比			1.3 :1 Max
波长			470-690 nm
插入损耗			4 % Max
单面反射率			1 % Max
增透膜标准			MIL-C-48497
光功率密度			250 W/mm ²
消光比			1000 :1 Min
偏振			90 ° To Mounting Plane

波长性能参数

波长(nm)	470	532	633	690
饱和射频功率 (W)	0.4	0.6	0.9	1.1
布拉格角 (mr)	11.2	12.7	15.1	16.4
光束分离角 (mr)	22.4	25.4	30.2	32.8

光束直径性能参数

光束直径(μm)	1000	1000	1000	1000
波长(nm)	470	532	633	690
衍射效率(%)	85	85	85	85
上升时间(ns)	159	159	159	159

*通光孔径：性能指标适用的光学孔径范围

外形尺寸图：

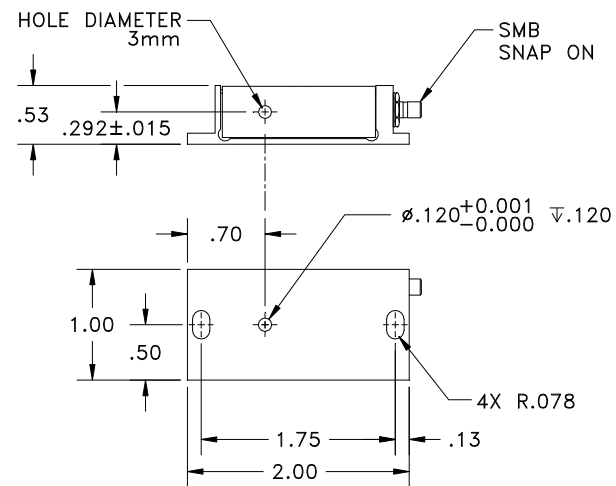

Document

10/31/13

Control

Notes:

- 1) All dimensions in inches unless specified otherwise.
- 2) cover Nickel plated



THIS DOCUMENT IS THE PROPERTY OF GOOCH AND HOUSEGO. IT IS NOT TO BE REPRODUCED OR DISCLOSED IN WHOLE OR IN PART OTHER THAN BY EMPLOYEES OF GOOCH AND HOUSEGO AND ITS CONTRACTED REPRESENTATIVES AND DISTRIBUTORS. ANY EXCEPTION REQUIRES THE WRITTEN CONSENT OF AN AUTHORIZED REPRESENTATIVE OF GOOCH AND HOUSEGO.

TOLERANCES: .XX ± .01 .XXX ± .005	DR	T. NG 10/8/2013			
MATERIAL:	CHK		DESCRIPTION: AOMO 3200-1214 200 MHz Frequency Shifter		
FINISH:	APP		PART NUMBER: 97-03036-02	REV: 2	SHEET 1 OF 1