

技术参数

| | | |
|-------|------------------------------|------------|
| 声光介质 | TeO ₂ | |
| 声速 | 4.2 mm/μs | |
| 通光孔径* | 2.5 mm 'L' X | 0.6 mm 'H' |
| 中心频率 | 165 MHz | |
| 射频带宽 | 50 MHz @ -10 dB Return Loss | |
| 输入阻抗 | 50 Ohms Nominal | |
| 驻波比 | 1.3 :1 Max | |
| 波长 | 1300-1550 nm | |
| 插入损耗 | 4 % Max | |
| 单面反射率 | 1 % Max | |
| 增透膜标准 | MIL-C-48497 | |
| 光功率密度 | 250 W/mm ² | |
| 消光比 | 1000 :1 Min | |
| 偏振 | 0° or 90 ° To Mounting Plane | |

波长性能参数

| | | | |
|------------|-------------|-------------|-------------|
| 波长(nm) | 1064 | 1300 | 1550 |
| 饱和射频功率 (W) | 2.6 | 3.25 | 4.5 |
| 布拉格角 (mr) | 20.9 | 25.5 | 30.5 |
| 光束分离角 (mr) | 41.8 | 51 | 61 |

光束直径性能参数

| | | | |
|---------------|------------|------------|------------|
| 光束直径(μm) | 400 | 380 | 380 |
| <i>波长(nm)</i> | 1064 | 1300 | 1550 |
| 衍射效率(%) | 70 | 60 | 50 |
| 上升时间(ns) | 78 | 78 | 81 |
| 调制带宽 | 7 | 7 | 7 |
| | NA | NA | NA |



*通光孔径：性能指标适用的光学孔径范围

外形尺寸图：

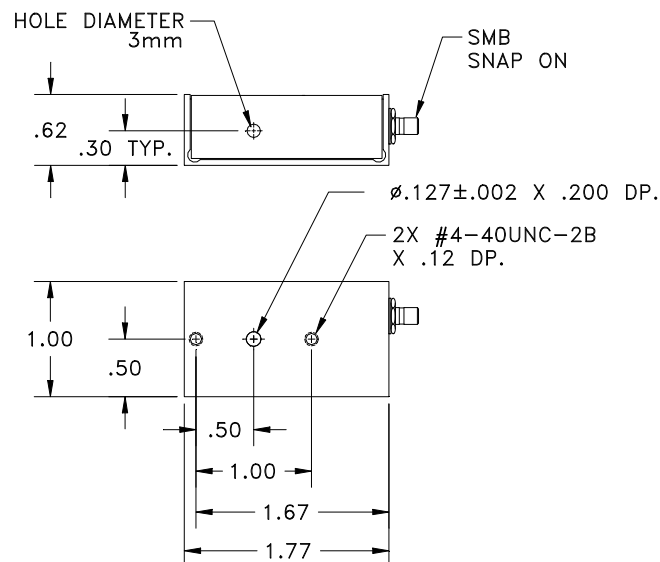

Document
10/31/13
Control

Notes:

Diffraction Efficiency refers to performance at 2 W RF Power.
Diffraction Efficiency at Saturation RF power is 65% min.
Carrier Frequency @ 1300 nm: 178 MHz; @ 1550 nm: 150 MHz.

THIS DOCUMENT IS THE PROPERTY OF GOOCH AND HOUSEGO. IT IS NOT TO BE REPRODUCED OR DISCLOSED IN WHOLE OR IN PART OTHER THAN BY EMPLOYEES OF GOOCH AND HOUSEGO AND ITS CONTRACTED REPRESENTATIVES AND DISTRIBUTORS. ANY EXCEPTION REQUIRES THE WRITTEN CONSENT OF AN AUTHORIZED REPRESENTATIVE OF GOOCH AND HOUSEGO.

| | | | | | |
|---|-----|-----------------------|--|------|--------------|
| TOLERANCES: .XX ± .01 .XXX ± .005 | DR | A. Campi 10/4/2013 | | | |
| MATERIAL: | CHK | | DESCRIPTION: AOMO 3165-1 1.3-1.55 μM, AEF | | |
| FINISH: | APP | | PART NUMBER: | REV: | SHEET 1 OF 1 |
| | APP | | 97-01287-02 | D | |